



**Ellis 42 Base** 42" x 42" x 24"

**Ellis 48 Base** 48" x 36" x 24"

**Ellis 60 Base** 60" x 32" x 24"  
60" x 36" x 24"

Acrylic Shower Base

**Features**

- Low 4" threshold for easy entry and exit
- Available with or without seat option



# Ellis Series

## Acrylic Shower Base

EB 4242 LS/RS • 42" x 42" x 24" • 1067 mm x 1067 mm x 610 mm

EB 4836 LS/RS • 48" x 36" x 24" • 1067 mm x 914 mm x 610 mm

EB6032 LS/RS • 60" x 32" x 24" • 1524 mm x 813 mm x 610 mm

EB6036 LS/RS • 60" x 36" x 24" • 1524 mm x 914 mm x 610 mm

### Product Features

- Vacuum formed acrylic reinforced with fiberglass
- Scratch, stain and fade resistant high gloss finish
- FD 2 chrome drain is included on all models

### Optional Accessories

- Acrylic wall option available
- FD 42 (Fixed Panel Pivot Door) is designed for the EB 4242
- Shower Door TD 48PS (Bypass Door) and FD 47 (Fixed Panel Pivot Door) are designed for the EB 4836 & EB48W
- Shower Door BDS 60PS (Bypass), FD 59 (Fixed Panel Pivot Door) are designed for the EB 6032 & EB 60W
- Shower Door BDS 60PS is designed for the shower base EB6036
- Roll Top Door Front Entry RT 60FPS is designed to fit the Shower Bases EB6036

### Meets or Exceeds the Following Specifications:

- CAN/CSA B45 Series
- CAN/ULC-S102.2-M88 Flame Spread FRP laminate rating

EB 4242 LS/RS • 1 Piece Shower Base with seat  
EB 4242 L/R • 1 Piece Shower Base no seat  
42" x 42" x 24" • 1 Piece Shower Base

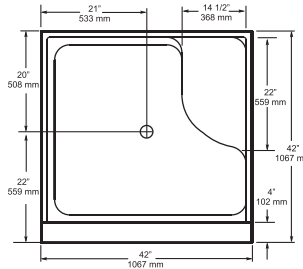

### General Specifications

Average weight	64 lbs	29 kg
Drain opening	3 1/4"	83 mm
Drain to floor clearance	1 3/4"	44 mm

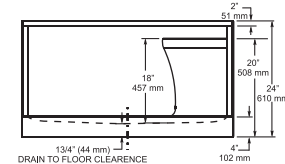

EB 4836 LS/RS • 1 Piece Shower Base with seat  
EB 4836 • 1 Piece Shower Base no seat  
48" x 36" x 24" • 1 Piece Shower Base

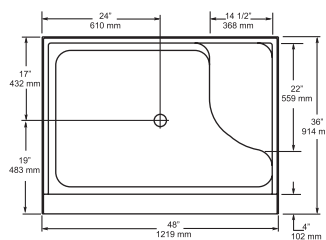

### General Specifications

Average weight	72 lbs	33 kg
Drain opening	3 1/4"	83 mm
Drain to floor clearance	1 3/4"	44 mm

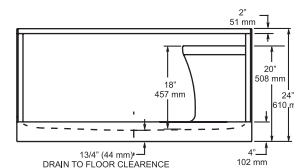

EB 6032 LS/RS • 1 Piece Shower Base with seat  
EB 6032 L/R • 1 Piece Shower Base no seat  
60" x 32" x 24" • 1 Piece Shower Base

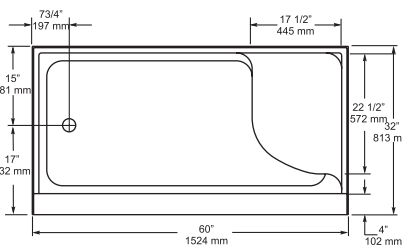

### General Specifications

Average weight	76 lbs	35 kg
Drain opening	3 1/4"	83 mm
Drain to floor clearance	1 3/4"	44 mm

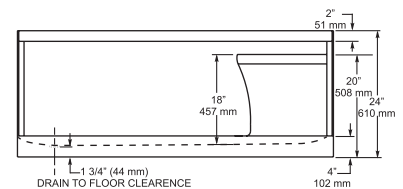

EB6036 LS/RS • 1 Piece Shower Base with seat  
EB6036 L/R • 1 Piece Shower Base no seat  
60" x 36" x 24" • 1 Piece Shower Base

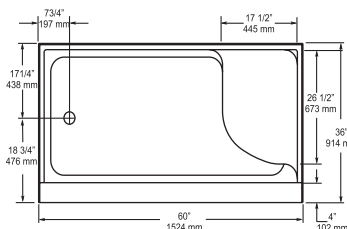

### General Specifications

Average weight	89 lbs	40 kg
Drain opening	3 1/4"	83 mm
Drain to floor clearance	1 3/4"	44 mm

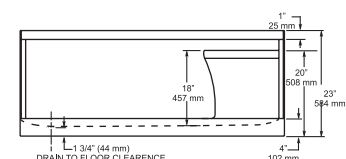

### NOTES:

Shower to be installed on the floor supported by the 2 feet and front edge. Shim if required to level the shower for adequate drainage.

### Important:

Dimensions of fixtures are nominal and may vary  $\pm 6$  mm (1/4"). These measurements are subject to change at Manufacturer's discretion.

### Mirolin Industries Corp

60 Shorncliffe Road, Toronto, ON M8Z 5K1  
mirolin.com support@mirolin.com  
T 416 231 5790 800 MIROLIN (647 6546)  
F 416 231 0929 800 463 2236



© Copyright 2010 Mirolin Ind. The Copyright includes all content on the document.